

## Gallet helmet adapters

User manual

31868C01  
2024-11

Copyright © 2024 Interspiro

This publication contains or refers to proprietary information which is protected by copyright. All rights are reserved. Interspiro®, Oxydive® and Divator® are registered trademarks belonging to Interspiro. This publication may not be copied, photocopied, reproduced, translated, or converted to any electronic or machinereadable form in whole or in part, without prior written approval from Interspiro.

# Table of Contents

Safety notice .....	5
Markings .....	6
Before use .....	7
Mount holders on face mask .....	7
Donning the face mask .....	7
After use .....	9
Doffing the face mask .....	9



## Safety notice



### **Warning**

The product must only be used by personnel in good health and trained in the use of respiratory protective equipment. Individuals with beards or large sideburns may not obtain an adequate seal. The face mask must be maintained, serviced and tested as described in this user manual, Interspiro service manuals and Interspiro test instructions.



### **Warning**

Interspiro is not responsible for:

- Combinations of products, unless put to market by Interspiro
- Changes or adaptations made to the product by a third party



### **Warning**

Changes to this document necessitated by typographical errors, inaccuracies of current information or improvements and changes of equipment may be made at any time without prior notice. Always refer to [www.interspiro.com](http://www.interspiro.com) for product updates, document updates and service bulletins. Exposure to extreme conditions may require other actions than described in this manual. The guarantees and warranties specified in the conditions of sale are not extended by this safety notice.

# Markings

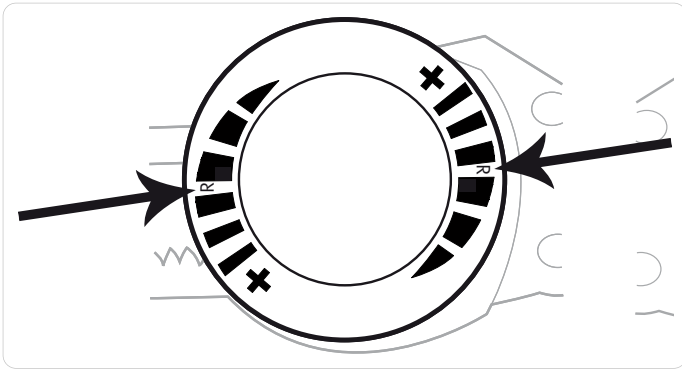

R - Right

L - Left

## Before use

### Mount holders on face mask

1. Remove head harness, buckles, holders and pins from the face mask.
2. Remove the screw that holds the frame halves together on one side of the face mask.
3. Assemble the link arm on the helmet adapter to the visor frame. Use one of the screws supplied with the helmet adapter.  
*The left hand link arm is marked with a "L", while the right hand link is marked with an "R".*
4. Repeat on the other side of the face mask.



#### Notice

The screws are inserted from the side without tread insert.



#### Notice

After mounting the face mask must be checked to be leak tight according to Interspiro test instructions.

### Donning the face mask

1. Put on the Gallet helmet (see helmet user manual).
2. Put on the breathing apparatus (see breathing apparatus user manual).
3. Pull out the orange hand wheels and turn them according to the arrows to fully extend the helmet adapters (see image).

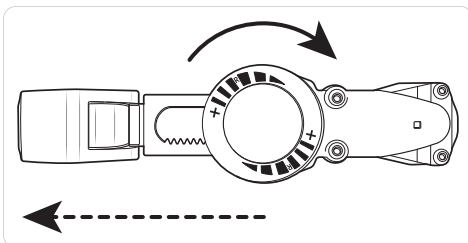

4. Push the face mask against the face.

## Gallet helmet adapters

5. Hook the link arms on the helmet adapter into the notches on the sides of the helmet.



6. At the same time, pull out both orange hand wheels and turn them simultaneously towards the “+” sign to tighten the helmet adapters (see image).

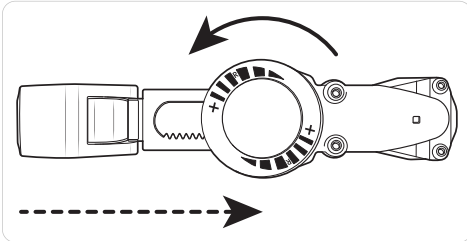

Do not over tighten the helmet adapters. Make sure that there is no hair in between the sealing surface of the face mask and the skin.



### Notice

Check the face seal before use, see face mask user manual.



## After use

### Doffing the face mask

1. If applicable, switch off the positive pressure.
2. Pull out the orange hand wheels and turn them according to the arrows to fully extend the helmet adapters.

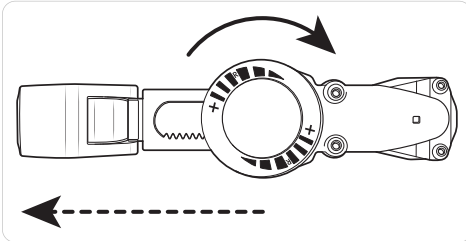

3. Disconnect the hooks on the helmet holders from the helmet and remove the face mask.
4. Pull out both orange hand wheels.
5. Turn both hand wheels towards the "+" signs to shorten each helmet adapter to its shortest position.

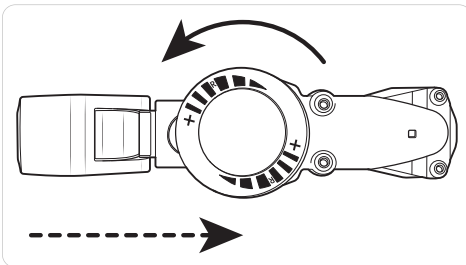

#### Notice

The helmet adapters shall always be washed and stored in its shortest position.







**INTERSPIRO**

Keeps You Breathing