



Product updates



Product news



Service advice



Safety advice

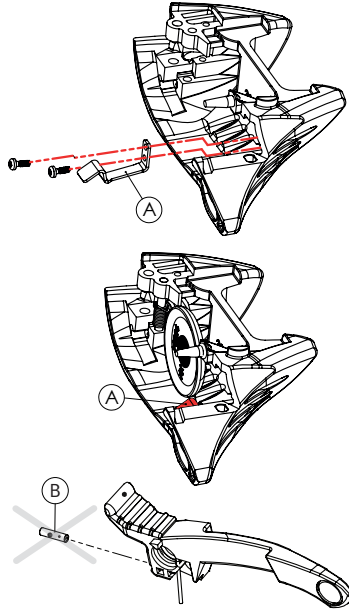

New locking mechanism on ambient air hatch

A new spring-loaded locking tab has been introduced (A). It keeps the exhalation cover in closed position when the indicator arm is pushed down.

This new locking mechanism replaces the adjusting screw (B) on the indicator arm.

Part numbers for masks and spare parts are unchanged. To upgrade mask with the new locking mechanism, the complete exhalation valve is replaced.

Part number: 99477-55



#Inspire

New desing of indicator arm



A new design on the indicator arm will be implemented, made in flexible rubber instead of hard plastic.

Part number: 99470-54



#S

#Inspire

New microphone design and new washing plug

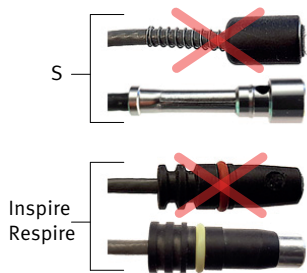

The microphones have a new design, reinforced with a pressed metal sleeve. The cable connection to the mask unit is also reinforced.

The new microphone washing plug fits both the new S, Inspire and Respire microphone design.

Part number: 35201-51



#Spirocom

New O-ring added in reserve air warning units

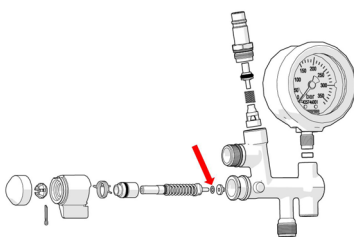

An additional O-ring has been added to get a better guiding of the valve disc, resulting in a more distinct warning.

The new O-ring has been added to products, spare parts and service kits.

If you have problems to pass the test of the reserve air warning it is recommended to add this O-ring on existing equipment.



#Incurve-R

#QS-R

#QS II-R

#Spiromatic