

Product updates



Product news



Service advice



Safety advice

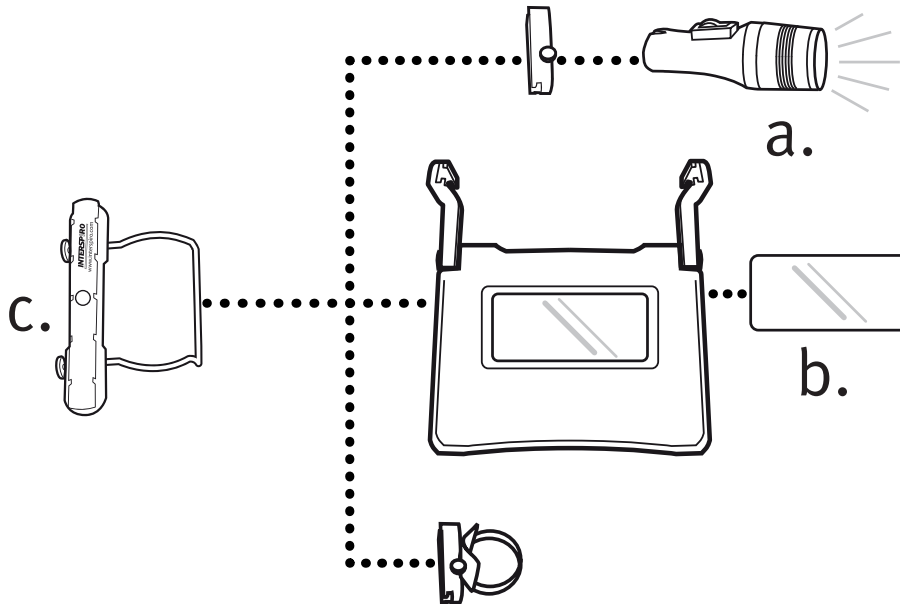

#Accessory rail system

Updated parts in the accessory rail system

- a,** The new Divelight is now available with part number 32316-52. It needs three AAA batteries (not included), has a 10-300 lumen variable output and it is depth rated to 100 meter.
- b,** The Auto-darkening glass is no longer available, it is replaced by a glass with 7 DIN, part number 30589-52, or a glass with 9 DIN, part number 30589-51. They are both sold with 5 pcs in each pack.
- c,** The metal shackles on the accessory rail has a slightly changed design and are now a bit wider.

Updated service instruction for breathing valves with mouthpiece

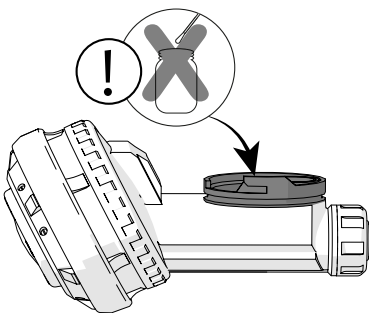

Wipe off the sealing surfaces thoroughly so there are no lubricants on them (grey area in image). Any remaining lubricant on the sealing surfaces may cause the mouthpiece to become loose.

The screw on the hose clip shall be tightened to 0,5 Nm. Use Torque screwdriver 88 748-53 with Bit kit 88 749-51.



#Mouthpiece

Using the RS4 regulator without a breathing valve

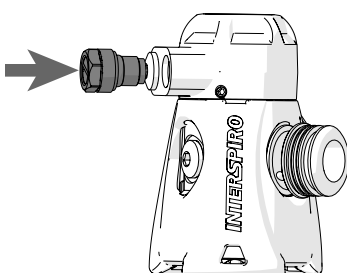

If the RS4 regulator shall be used without a Divator breathing valve (which can release overpressure) connected to it, it must be equipped with a relief valve.



#RS4